



MACROFAB

Electronics manufacturing, redefined.



ACE OFFICE FURNITURE

HOUSTON

Presentation By **Robert Lozano**

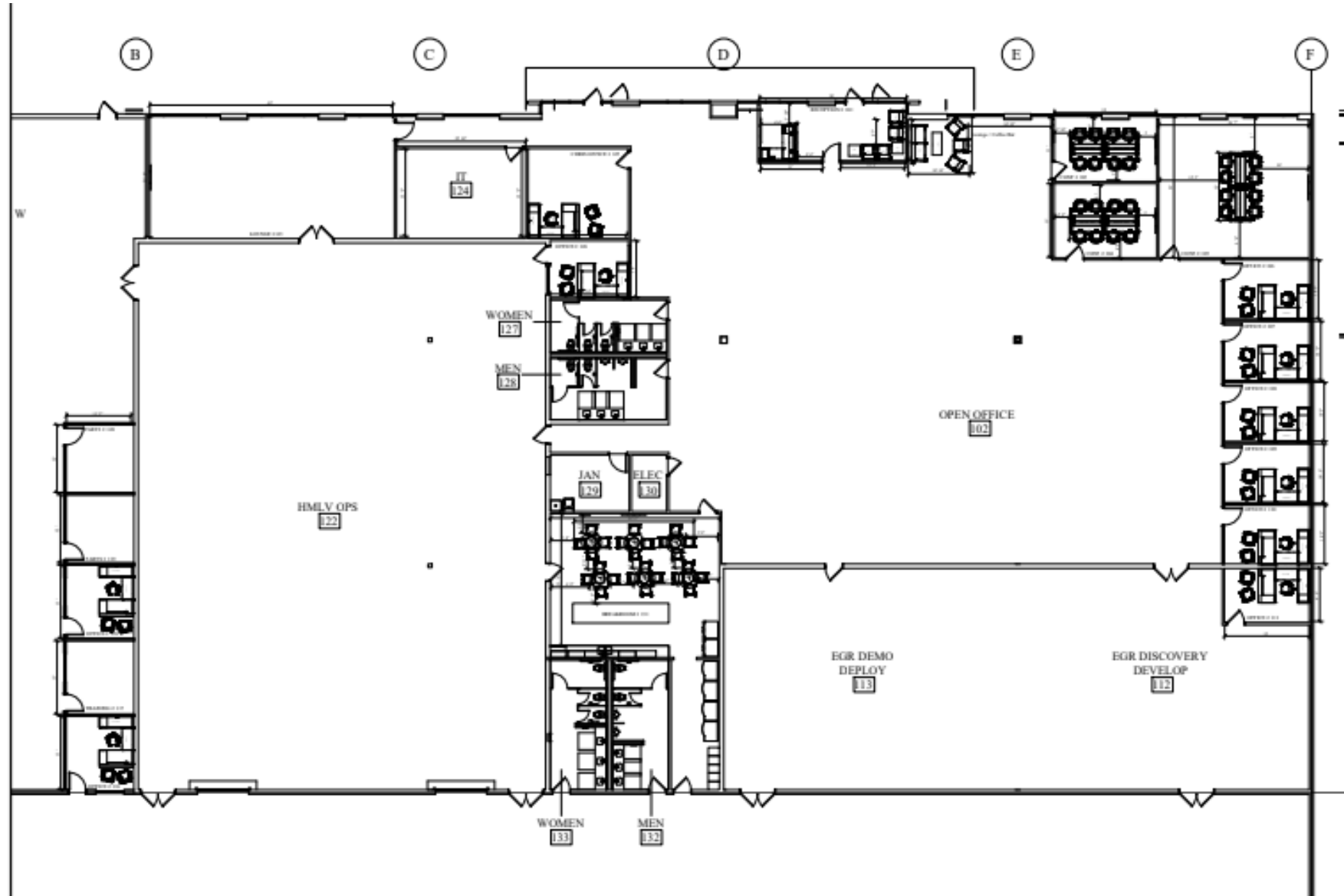



U-Shaped Desk

Zira™

Introduces walls with floating shelves and storage elements that deliver a custom millwork look to any space without the additional cost. Height adjustable desk integration, new fixed height desk options, frameless glass sliding doors and more are the latest additions to the Zira desking series that will personalize your workspace.



Handles



Bar Silver



Bar Black



Square edge Silver



Square edge Black



Flared Silver



Flared Black



Flared Brass



Crescent Black



Dimpled Nickel



1.5" standard flat edge



1.5" bicut edge



1.5" fluted edge



Absolute Acajou
(ACJ)



Asian Night
(ASN)



Avant Cherry
(AWC)



Avant Honey
(AWH)



Black
(BLK)



Brushed Cobalt
(BRC)



Clear Maple
(CMB)



Dark Espresso
(DCS)

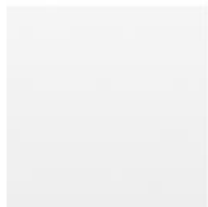

Designer White
(DWT)



Hayden Grey
(HGT)



Noce Biondo
(NBL)



Noce Grigio
(NGL)



Noce Leggero
(NEL)



Noce Medio
(NML)



Walnut Heights
(WHD)



Quartered Mahogany
(QTM)



Storm Grey
(SOG)



Tiger Fruitwood
(TFW)



Tiger Walnut
(TWL)



White Chocolate
(WHC)



Willow Grey
(WGY)



Winter Cherry
(WCR)



ALL TASK SEATING



The Vion™ family is not only design savvy, but is adaptable to any office or meeting room environment. Two back heights and five mechanisms are offered along with mesh and upholstered back varieties. With the inclusion of drafting stools, guest seating, counter height and bar height stools, as well as heavy duty models, the Vion family becomes an excellent choice for the modern office.

Dimensions: W25.5 x D24 x H38 IN.



ACE OFFICE FURNITURE

HOUSTON



CONFERENCE SEATING

Prefer™ Multi-Task Chair



Introducing **Prefer™** An enduring design updated with a sleek mesh back and exquisite arms in Polished Aluminum or matching polymer. Lifetime warranty because you won't want to let it go. Dimensions: W25.5 x D25 x H36 IN.



ACE OFFICE FURNITURE
HOUSTON



ALL GUEST SEATING



Multi-purpose seating with a sculptured look, featuring wide curved arms and a round tubular steel frame.

- Four-legged side chairs are "wall safe". Rear legs hit the baseboard first leaving clearance between the back of the chair and the wall, saving both the chair and the wall from damage.
- The rugged frame comes in a choice of Black, Tungsten, or Chrome finish.
- Arms are wide and full length, offering support to help stabilize users as they sit or exit the chair. The gently curved arms are made from incredibly strong fiberglass reinforced nylon. Armless models are available.
- Sidero is equipped with a polypropylene seat shroud that helps stabilize chairs when stacked and avoid frame imprints on upholstered seats.
- Models with casters stack 3 high on the floor. Stools and sled base models do not stack.
- Designed by Zoey Chu.



ACE OFFICE FURNITURE

HOUSTON



Square Corner Edge - Silver



Square Corner Edge - Black



Rounded Corner (Bubble) Edge - Silver



Rounded Corner (Bubble) Edge - Black



2mm Matching Edge



2mm Matching Bicut Edge



Tapered Legs with Leveler Glides



Tapered Legs with Optional Locking Casters



Spider Legs with Leveler Glides



Spider Legs with Optional Locking Casters



Flip-Tops

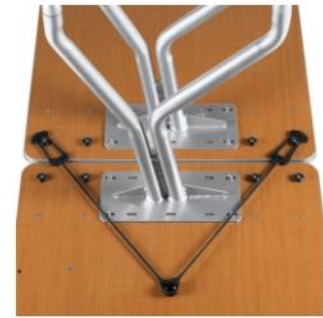

Tool Free Ganging

Bungee™ Tables

Versatile, efficient, economical.

- Bungee comes complete with table tops, legs and Bungee cords, allowing quick and easy reconfiguring of table settings without using any tools. The multi-use Bungee Tables are an affordable investment for growing companies looking for versatile and efficient meeting solutions.
- Ideal for classrooms, training rooms and boardroom settings.
- Moving from classroom to collaborative settings and back again is easy with Bungee.
- Individual tables are available in a wide range of surface shapes
- and are easily combined to quickly transform into whatever setting is required.
- Optional rectangular shaped modesties provide seated privacy.
- Available in fixed or flip-top surfaces.



ACE OFFICE FURNITURE

HOUSTON



Zira™

- Reception Desk -



ACE OFFICE FURNITURE
HOUSTON



Wind™

The simple geometry and slim proportions of the Wind series creates a relaxed and open atmosphere even when space is at a premium.

- A durable steel tubular base with fully upholstered fixed cushions.
- Base and legs are standard in Chrome. Black, Charcoal and Tungsten are available at no charge.
- Coordinates with Wind tables.
- Tables are available with an epoxy painted finish in Charcoal and White or any Global laminates.



ACE OFFICE FURNITURE
HOUSTON



Popcorn™

Armless Barstool,
Polypropylene Seat & Back



Color it your way



ACE OFFICE FURNITURE

HOUSTON



Swap™

Tables – the right proportions, flawless surfaces and a solid foundation. Squares or rounds at the floor with integrated leveling. All the popular sizes and more. Seven heights and a great selection of laminates.



ACE OFFICE FURNITURE

HOUSTON

ACE
OFFICE FURNITURE
HOUSTON



Category Winner
2017,2018,2019,2020,2021



MARQUIS
Who's Who[®]



 **ACE OFFICE FURNITURE**
HOUSTON